

Orb 6



A sleek, spherical luminaire with a stem mount, available in a six inch diameter with five shades to fit in any modern space.

Features

- Metal pendant stem mounting
- Remote and dimmable drivers
- Aluminum core LED boards
- Specifiable color temperature. CRI > 90, R9 > 50
- 5 Year, 50,000 hour warranty, damp location rated

Dimensions

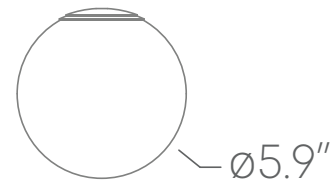

Optional Shades



Saturn



Mercury



Mars



Venus Luma



Venus Astra

Ordering Information

For each option group below specify one option. If you don't see your preferred option listed, contact us for [help](#).

1	Fixture ID	2	Shade	3	Color Temperature	4	Output								
	ORB.6	NA	No shade	27	2700K/90 CRI	MED	Medium output								
		STN	Saturn 12-inch nominal shade <small>See page 3 for details.</small>	30	3000K/90 CRI										
		MRS	Mars 17-inch nominal shade. <small>See page 3 for details.</small>	35	3500K/90 CRI										
		MC	Mercury 6-inch nominal shade. <small>See page 3 for details.</small>	40	4000K/90 CRI										
		VNLM	Venus Luma 10-inch nominal shade <small>See page 3 for details.</small>												
		VNAST	Venus Astra 14-inch nominal shade <small>See page 3 for details.</small>												
5	Voltage	6	Driver	7	Outer shade finish	8	Finial Finish								
	UNV Universal (120/277V)	DB	Standard 0-10V 1%	W	White	W	White								
		DB.1%	0-10V 0.1%	BLK	Black	BLK	Black								
		ELV	Reverse phase 1% (120V only)	GLD	Pearl gold (RAL 1036)	GLD	Pearl gold (RAL 1036)								
		TRI	Forward phase	BLU	Gentian blue (RAL 5010)	BLU	Gentian blue (RAL 5010)								
		LDE1	Lutron Digital EcoSystem	RED	Carmine red (RAL 3002)	RED	Carmine red (RAL 3002)								
		DALI	DALI-2 driver	CC	Custom color See finish options here	CC	Custom color See finish options here								
		PoE	Power over ethernet	NA	None <small>Only specify if no shade.</small>	NA	None <small>Only specify if no shade.</small>								
		DMX	DMX512 <small>All DMX drivers set to default address 001 and provided in remote enclosers. Contact us for other addressing needs.</small>												
		JA8	JA8 compliant 1% dimming												
9	Stem finish	10	Canopy finish	11	Mounting	12	Sensors/Controls								
	W White	W White	W White	PS.X	Pendant stem with standard 5-inch canopy. 12, 18, 24, 36, or 48 in. Consult factory for lengths not shown.	NA	None								
	BLK Black	BLK Black	BLK Black			AWNDR	Lutron Athena wireless node								
	CC Custom color See finish options here	CC Custom color See finish options here	CC Custom color See finish options here	PSFC	Field cuttable pendant stem 94 in. stem field cuttable to any length.	CCS	Casambi module								
	NA None <small>No stem. Cable mount.</small>														
13	Circuit	Performance													
	NA None	<table border="1"> <thead> <tr> <th>Shade¹</th> <th>Watts</th> <th>Lumens</th> <th>LPW</th> </tr> </thead> <tbody> <tr> <td>NA</td> <td>14.5</td> <td>834</td> <td>58</td> </tr> </tbody> </table>						Shade ¹	Watts	Lumens	LPW	NA	14.5	834	58
Shade ¹	Watts							Lumens	LPW						
NA	14.5							834	58						
EMPCK	Emergency battery pack														
EMCKT	Emergency circuit <small>May require additional power feeds.</small>														



Drivers & Electrical

Remote, dimmable drivers are supplied in enclosures. Linear dimming curve by default. Consult factory for logarithmic options.

For remote driver box sizes, click [here](#).

Emergency Back-Up

A 6W remote emergency driver may be wired. Emergency circuits for use with building generators are also available.

Weight

TBD

Shade Shapes

Optics

Glass optic provides excellent diffusion and no LED imaging.

Finishes

Pendant stem is made of steel tubing. The standard color of the stem is black. The outer shades can specified to match any RAL color. The inner shade is always white.

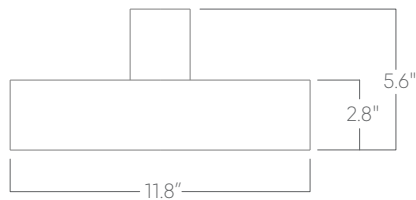

Saturn

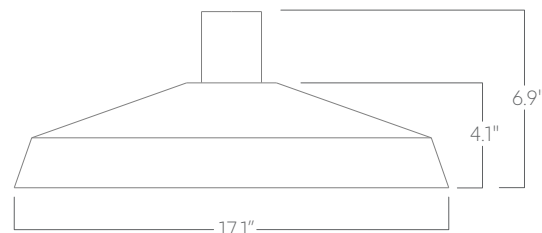

Mars

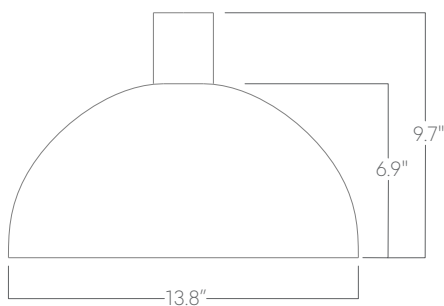

Venus Astra

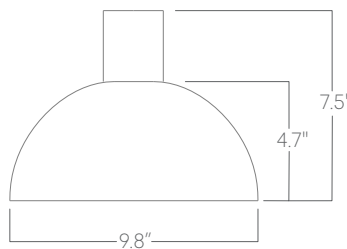

Venus Luma

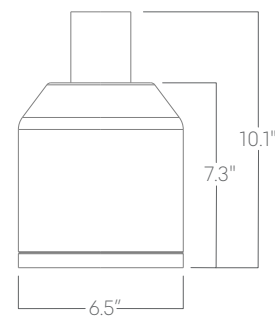

Mercury

Mounting Options

Custom mounting types and ceiling transitions available; consult factory.
Mounting and power feed locations will be added to approval drawings on request.

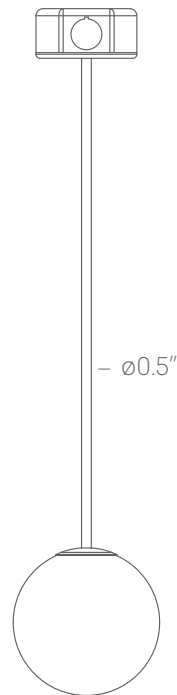

Pendant stem

Please consult factory shop drawings for suspension points.

To prevent damage to fixtures, factory designated suspension points must not be field altered.

Do not attempt installation if you do not understand the installation instructions.