

Orb 4



A sleek, spherical luminaire with a stem mount, available in a four inch diameter with five shades to fit in any modern space.

Features

- Metal pendant stem mounting
- Remote and dimmable drivers
- Aluminum core LED boards
- Specifiable color temperature. CRI > 90, R9 > 50
- 5 Year, 50,000 hour warranty, damp location rated

Dimensions

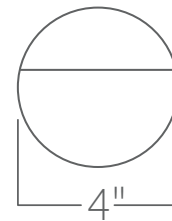

Optional Shades



Saturn



Mercury



Mars



Venus Luma



Venus Astra

Ordering Information

For each option group below specify one option. If you don't see your preferred option listed, contact us for [help](#).

| 1 | Fixture ID | 2 | Shade | 3 | Color Temperature | 4 | Output | | | | | | | | |
|--------------------|---|--|--|-------------|--|--------------|---|--------------------|-------|--------|-----|----|---|-----|----|
| ORB.4 | | NA | No shade | 27 | 2700K/90 CRI | MED | Medium output | | | | | | | | |
| | | STN | Saturn 12-inch nominal shade <small>See page 3 for details.</small> | 30 | 3000K/90 CRI | | | | | | | | | | |
| | | MRS | Mars 17-inch nominal shade. <small>See page 3 for details.</small> | 35 | 3500K/90 CRI | | | | | | | | | | |
| | | MC | Mercury 6-inch nominal shade. <small>See page 3 for details.</small> | 40 | 4000K/90 CRI | | | | | | | | | | |
| | | VNLM | Venus Luma 10-inch nominal shade <small>See page 3 for details.</small> | | | | | | | | | | | | |
| | | VNAST | Venus Astra 14-inch nominal shade <small>See page 3 for details.</small> | | | | | | | | | | | | |
| 5 | Voltage | 6 | Driver | 7 | Outer shade finish | 8 | Finial Finish | | | | | | | | |
| UNV | Universal (120/277V) | DB | Standard 0-10V 1% | W | White | W | White | | | | | | | | |
| | | DB.1% | 0-10V 0.1% | BLK | Black | BLK | Black | | | | | | | | |
| | | ELV | Reverse phase 1% (120V only) | GLD | Pearl gold (RAL 1036) | GLD | Pearl gold (RAL 1036) | | | | | | | | |
| | | TRI | Forward phase | BLU | Gentian blue (RAL 5010) | BLU | Gentian blue (RAL 5010) | | | | | | | | |
| | | LDE1 | Lutron Digital EcoSystem | RED | Carmine red (RAL 3002) | RED | Carmine red (RAL 3002) | | | | | | | | |
| | | DALI | DALI-2 driver | CC | Custom color See finish options here | CC | Custom color See finish options here | | | | | | | | |
| | | PoE | Power over ethernet | NA | None <small>Only specify if no shade.</small> | NA | None <small>Only specify if no shade.</small> | | | | | | | | |
| | | DMX | DMX512 <small>All DMX drivers set to default address 001 and provided in remote enclosers. Contact us for other addressing needs.</small> | | | | | | | | | | | | |
| | | JA8 | JA8 compliant 1% dimming | | | | | | | | | | | | |
| 9 | Stem finish | 10 | Canopy finish | 11 | Mounting | 12 | Sensors/Controls | | | | | | | | |
| W | White | W | White | PS.X | Pendant stem with standard 5-inch canopy. <small>12, 18, 24, 36, or 48 in. Consult factory for lengths not shown.</small> | NA | None | | | | | | | | |
| BLK | Black | BLK | Black | | | AWNDR | Lutron Athena wireless node | | | | | | | | |
| CC | Custom color See finish options here | CC | Custom color See finish options here | PSFC | Field cuttable pendant stem <small>94 in. stem field cuttable to any length.</small> | CCS | Casambi module | | | | | | | | |
| NA | None <small>No stem. Cable mount.</small> | | | | | | | | | | | | | | |
| 13 | Circuit | <h2>Performance</h2> | | | | | | | | | | | | | |
| NA | None | <table border="1"> <thead> <tr> <th>Shade¹</th> <th>Watts</th> <th>Lumens</th> <th>LPW</th> </tr> </thead> <tbody> <tr> <td>NA</td> <td>8</td> <td>512</td> <td>64</td> </tr> </tbody> </table> | | | | | | Shade ¹ | Watts | Lumens | LPW | NA | 8 | 512 | 64 |
| Shade ¹ | Watts | | | | | | | Lumens | LPW | | | | | | |
| NA | 8 | | | | | | | 512 | 64 | | | | | | |
| EMPCK | Emergency battery pack | | | | | | | | | | | | | | |
| EMCKT | Emergency circuit <small>May require additional power feeds.</small> | | | | | | | | | | | | | | |

¹Based on a typically configured 90 CRI, 3500K luminaire using one driver. MR lamps are 8 Watts, 383 lumens each. Custom outputs available. Please consult factory. For 4000K multiply by 1.05; for 3000K, 0.96; for 2700K, 0.92.



Wiring diagrams, PoE and sensor details

Click or Scan



Drivers & Electrical

Remote, dimmable drivers are supplied in enclosures. Linear dimming curve by default. Consult factory for logarithmic options.

For remote driver box sizes, click [here](#).

Emergency Back-Up

A 6W remote emergency driver may be wired. Emergency circuits for use with building generators are also available.

Weight

TBD

Shade Shapes

Optics

Glass optic provides excellent diffusion and no LED imaging.

Finishes

Pendant stem is made of steel tubing. The standard color of the stem is black. The outer shades can specified to match any RAL color. The inner shade is always white.

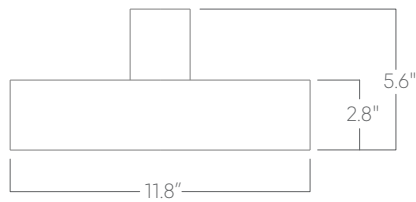

Saturn

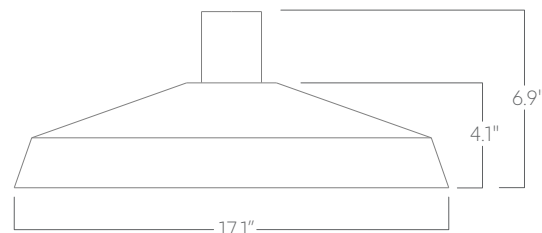

Mars

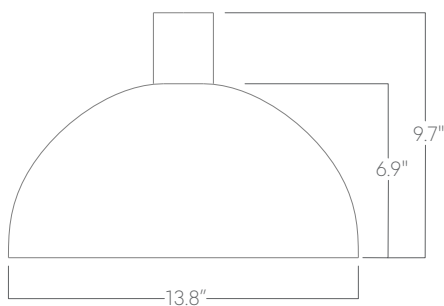

Venus Astra

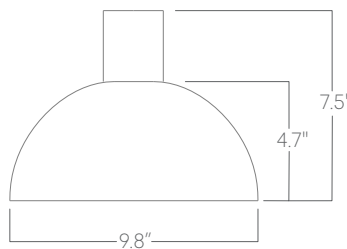

Venus Luma

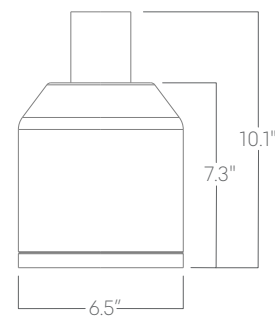

Mercury

Mounting Options

Custom mounting types and ceiling transitions available; consult factory.
Mounting and power feed locations will be added to approval drawings on request.

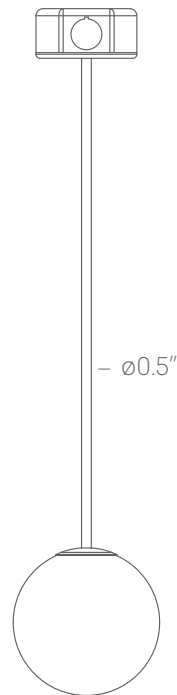

Pendant stem

Please consult factory shop drawings for suspension points.

To prevent damage to fixtures, factory designated suspension points must not be field altered.

Do not attempt installation if you do not understand the installation instructions.