

# Bulb module



Linear module using specially designed, drop-below rounded lens for a unique aesthetic.

## Features

- Magnetically held and easily repositioned on site
- Available in lengths up to 8' (5.5" increments)
- Extruded, recycled, premium aluminum housing
- Specifiable color temperature. CRI > 90, R9 >50
- 5 Year, 50,000 hour warranty

## Dimensions

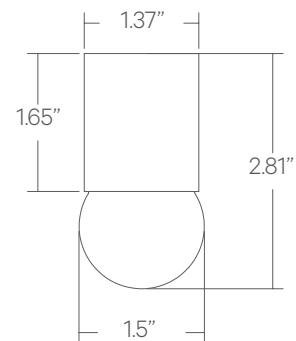

## Optics

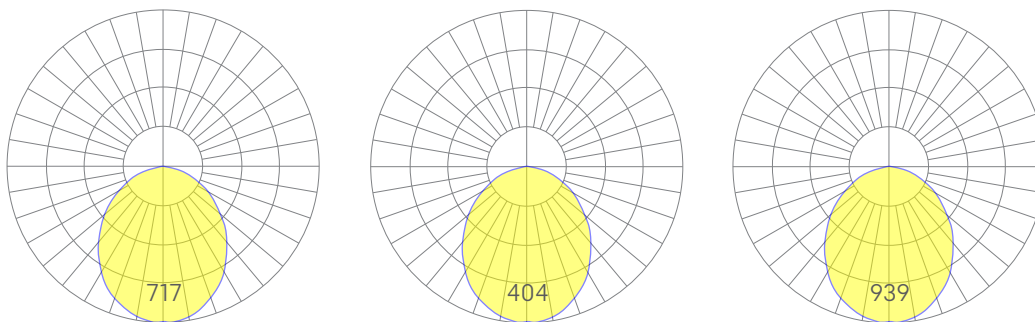

Representative distribution and peak candela. For other options see order information or IES files [here](#).

# Bulb module



## Ordering Information

-  -  -  -  -   
 1            2            3            4            5            6

Example:            MAG-BLB - 2' - 35 - MED - W - NA

<b>Fixture ID</b>	<input type="text" value="1"/>	<b>Length (Nominal)</b>	<input type="text" value="2"/>	<b>Color Temperature</b>	<input type="text" value="3"/>	<b>Finish</b>	<input type="text" value="4"/>
<b>MAG-BLB</b>		1    1 ft 2    2 ft 4    4 ft 6    6 ft 8    8 ft X'    Specify length		27    2700K/90 CRI 30    3000K/90 CRI 35    3500K/90 CRI 40    4000K/90 CRI		<b>LOW</b> Low output <b>MED</b> Medium output <b>HIGH</b> High output	
<small>*Custom lengths up to 8'. Specify to the nearest 6" increments.</small>							
<b>Finish</b>	<input type="text" value="5"/>	<b>Circuit</b>	<input type="text" value="6"/>				
<b>W</b> White <b>BLK</b> Black <b>CC'</b> Custom Color		<b>NA</b> None <b>EM120V</b> Emergency Pack <b>EM277V</b> Emergency Pack <b>EMCKT</b> Emergency Circuit					
<small>*Custom Color. See finish options here.</small>		<small>*EM sections are fixed in position at the factory by code and must be marked on the submittal drawing.</small>					

## Performance

Output <sup>1</sup>	Watts/ft	Lumens/ft
Low	4.5	240
Medium	8	425
High	13	545

Based on a typically configured 90 CRI, 3500K luminaire using one driver.

<sup>1</sup>For 4000k, multiply by 1.05; for 3000k, 0.96; for 2700k, 0.92.