

DATE _____ PROJECT _____ FIRM _____ TYPE _____

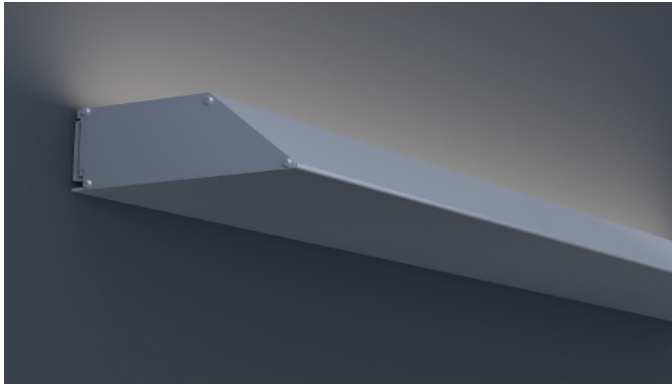

FEATURES

- Cove System with Easy-to-Install Wall Mount Bracket
- Field Paintable to Match Any Wall Color
- Available In Made To Measure Lengths Accurate Up To 1/16"
- Damp Location Rated
- CRI 90+ Standard; R9>50
- 5 Year, 50,000 Hour Fixture Warranty
- 2700K, 3000K, 3500K, 4000K & 5000K Color Temperatures Available

APPLICATIONS Offices, Lobbies, Retail Stores, Classrooms, Reception Areas, & Corridors

FINISH Standard Powder-Coated White with Optional Field Paintable White Coating Allowing for Custom RAL Colors Available

CONSTRUCTION Extruded Aluminum Housing

OPTICS Extruded High Transmission Satin Acrylic Lens with No LED Imaging. Dust Cover Provided

FIXTURE RATINGS & CERTIFICATIONS Union Made ETL Listed Made In The USA Damp Location Rated



DRIVERS & SENSORS

For Wiring Diagrams and Sensor Information Click [Here](#)



ELECTRICAL Integral Driver with 0-10V Dimming Standard. Several Driver Options Available

EXTRUSION DIMENSIONS

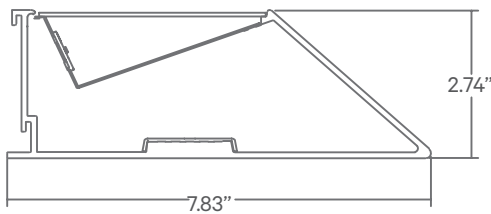

LED SYSTEM INFORMATION

	Nominal System Watts	Nominal Delivered Lumens	Nominal Efficacy
Standard (LTG1)	7.25 W/ft	875 lm/ft	120 LPW
Low (LTG2)	5 W/ft	600 lm/ft	120 LPW
High (LTG3)	10 W/ft	1,165 lm/ft	116 LPW

Based on a 3500K luminaire using one driver. Custom outputs available; specify below.

ORDERING



1 - FIXTURE ID

WB KOVE

2 - LENGTH

- 4 - 4 ft
- 8 - 8 ft
- X'-X" - Specify Length

3 - COLOR TEMP

- 27 - 2700K/90 CRI
 - 30 - 3000K/90 CRI
 - 35 - 3500K/90 CRI
 - 40 - 4000K/90 CRI
 - 50 - 5000K/90 CRI
 - WD* - Warm Dim 2200K-3000K
 - TW** - Tunable White 2700K-6500K
 - RGBW30*** - RGB + 3000K
 - RGBW35*** - RGB + 3500K
- *Requires WD10 Driver
**Requires DMX or TW10 Driver
***Requires DMX Driver

4 - LED SYSTEM

- LTG1 - Standard
- LTG2 - Low
- LTG3 - High
- LTGC - Custom Output

5 - VOLTAGE

- UNV - Universal (120/277V)
 - 347V* - 347V
- *Must use DB Driver

6 - DRIVER

- DB - Standard 1% Dimming (0-10V)
- DB.1% - 0.1% Dimming (0-10V)
- ELV-TRI - 2-wire 1% Dimming (120V only) ELV and TRIAC Compatible
- LDE1 - Lutron Digital EcoSystem
- DALI - DALI-2 Driver
- PoE - Power over Ethernet. Consult Factory for Compatibility
- DMX - For Color Tuning and RGBW (Remote)
- TW10 - Dual Channel, 0-10V For Color Tuning (CCT and Intensity Control)
- WD10 - 0-10V Driver For Warm Dimming
- PSQ - Lutron 0-10V For Color Tuning

7 - FINISH

- W - White (Standard)
- FPW - Field Paintable White
- CC - Custom Color (provide RAL#)

8 - REFLECTOR

STD - Standard

9 - OTHER OPTIONS

- EM 120V - Emergency Pack
- EM 277V - Emergency Pack
- EMCKT - Emergency Circuit

MOUNTING INFORMATION

STEP 1

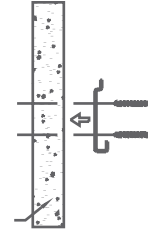
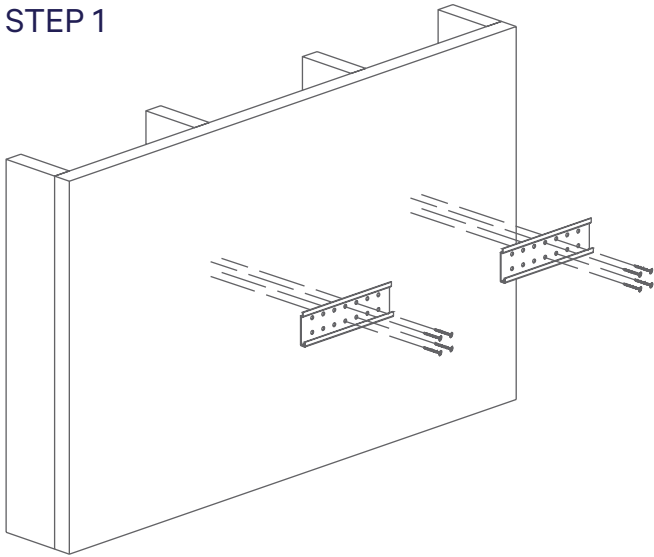

DETAIL

STEP 2

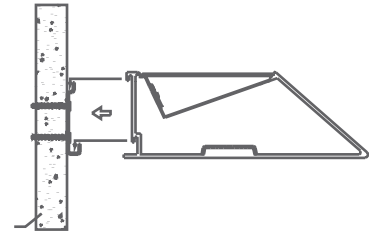
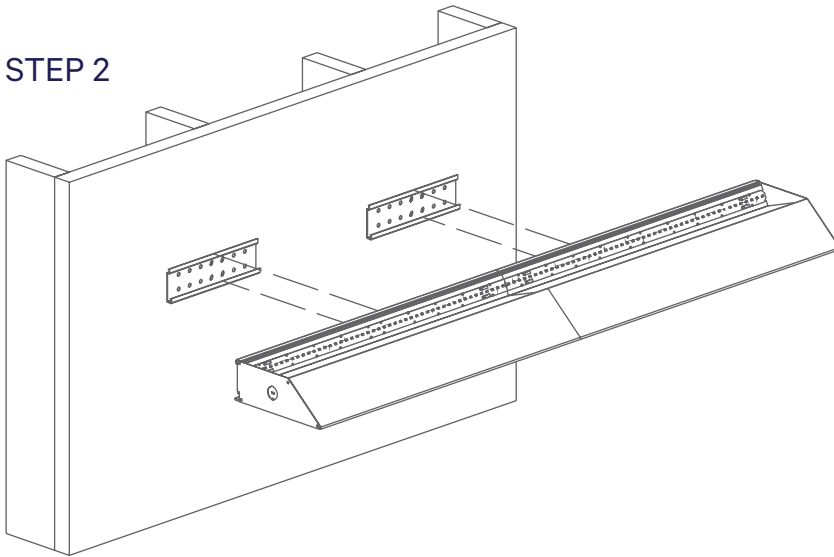

DETAIL