

Rush Black Optic recessed

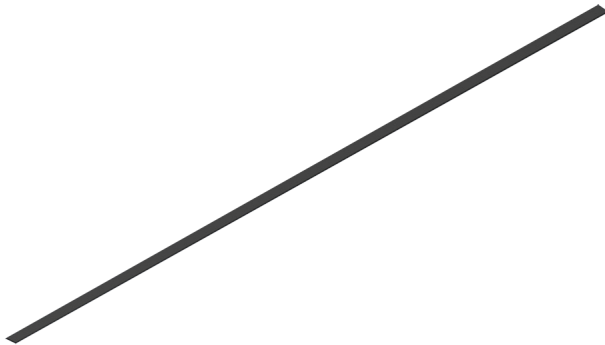

The Black Optic Series of architectural luminaires seamlessly blends into dark surroundings. Custom lengths and patterns are tailored to suit any modern space.

Features

- Extruded recycled aluminum housing
- Aluminum core LED boards, specifiable output
- Specifiable color temperature. CRI > 90, R9 > 50
- Custom lengths, welded patterns, and finishes available
- Integral specifiable dimmable drivers or PoE
- 5 Year, 50,000 hour warranty, damp location rated
- Compatible with all wood ceilings
- WELL Building Standard compatible [learn more](#)

Dimensions

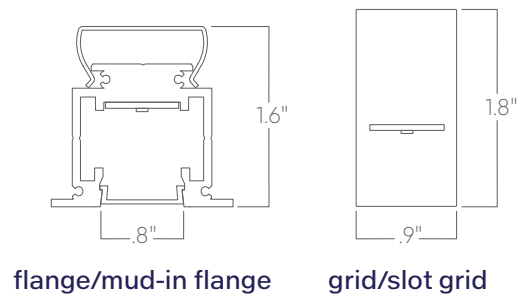

flange/mud-in flange

grid/slot grid

Optics

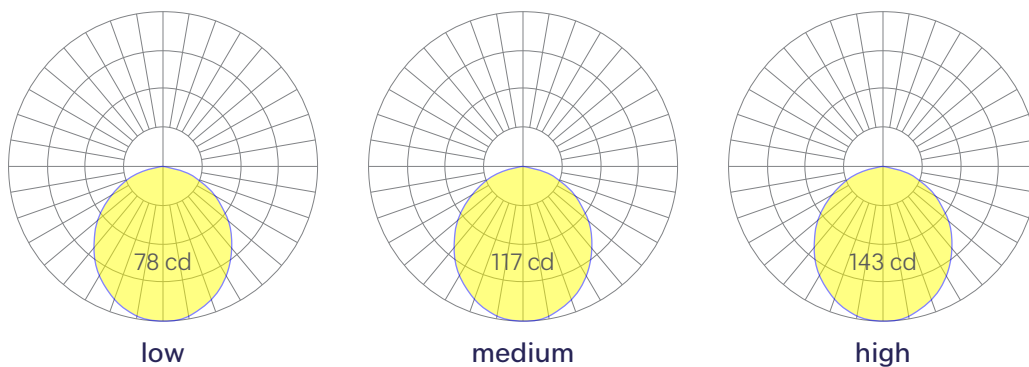

Representative distribution and peak candela. For other options see order information or IES files [here](#).

Rush Black Optic recessed

Ordering Information

For each option group below specify one option. If you don't see your preferred option listed, contact us for [help](#).

1 Fixture ID	2 Length	3 Color Temperature	4 Output
RUSH BKO REC	2 2 ft 4 4 ft 8 8 ft X'-X" Specify Length PAT Pattern (Consult Factory)	27 2700K/90 CRI 30 3000K/90 CRI 35 3500K/90 CRI 40 4000K/90 CRI	LOW Low output MED Medium output HIGH High output CUST Custom output <small>Specify watts or lumens</small>
5 Voltage	6 Driver	7 Finish	8 Mounting
UNV Universal (120/277V) 347V 347V <small>Available for DB driver only</small>	DB Standard 0-10V 1% DB.1% 0-10V 0.1% ELV Reverse Phase 1% (120V only) <small>For compatible dimmers, click here.</small> TRI Forward phase (120V only) <small>For compatible dimmers, click here.</small> LDE Lutron Digital EcoSystem DALI DALI-2 Driver PoE Power over Ethernet. DMX DMX512 <small>All DMX drivers set to default address 001 and provided in remote enclosures. Contact us for other addressing needs.</small>	W White BLK Black SLV Silver CC Custom Color <small>See finish options here.</small> CWF Custom Wood Finish <small>See finish options here.</small>	T 9/16" Tee Grid TI5 15/16" Tee Grid SG Slot Grid/Interlude F Flange NT Mud-in Flange PM-X Perimeter Mount <small>*X denotes mounting type on opposite side of wall (eg PM-NT).</small> WOOD Wood ceiling <small>Provide specifications.</small>
<small>All drivers provided in remote enclosures</small>			
9 Optics	10 Sensors/Controls	11 Circuit	12 Options
BKO Black Optic	NA None ACM Acuity nLight Module Only CCS Casambi Module AWN Lutron Athena Wireless Node Module OTHER Consult Factory	NA None EMCKT Emergency circuit DAYCKT Daylight circuit <small>May require additional power feeds.</small>	STD White canopy + white cord CAN-X Canopy + color <small>See finish options here.</small> SJ-BLK Black cord SJ-WHT White cord
<small>All controls remote.</small>			

Performance

Output ¹	Watts/ft	Lumens/ft
Low	4	53
Medium	5	79
High	7	100

¹Based on a typically configured 90 CRI, 3500K luminaire using one driver. Custom outputs available. Please consult factory. For 4000K multiply by 1.05, for 3000K, 0.9, for 2700K, 0.92.

Technical Information



click [here](#) or scan QR code

Wiring diagrams, PoE and sensor details

Rush Black Optic recessed

Drivers & Electrical

Remote, dimmable drivers are supplied in enclosures.
For remote driver box sizes, click [here](#).

Sensors & Controls

Sensors are installed remotely from the fixture. Coronet remains agnostic in our approach to sensors and control systems; our fixtures are compatible with most systems offered.

Emergency Back-Up

Emergency circuits for use with building generators available.

PoE (Power over Ethernet)

Compatible with virtually all PoE systems including Moxel Coresync, Igor, Smartengine, Platformatics, and NuLED SPICEbox.
Consult factory for systems not listed. See [here](#) for more info.

Finishes

All luminaires are finished in high quality polyester powder coating. Our standard color is white. Any RAL color may be specified.

Weight

1 lb per foot

Optics

Room facing lens is black when unilluminated, seamlessly blending into dark environments. Uplight is available for some models.

Construction

Housings are extruded premium, recycled aluminum. Individual fixtures are available up to 12' long and may be specified as nominal or precision lengths. Precision lengths are supplied within 1/8" tolerance.

Joined Runs

Runs of any length may be specified and are comprised of multiple, factory-engineered, joined sections. Individually specified luminaires are not field joinable.

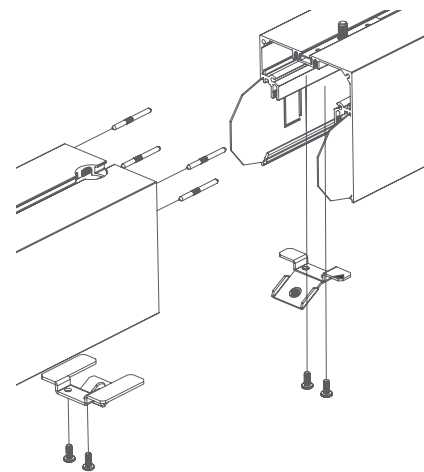

Representative joinery. For product specific details see installation guides or submittal drawings.

Patterns

Featuring illuminated welded corners and angles. Consult factory for custom designs and elevations.

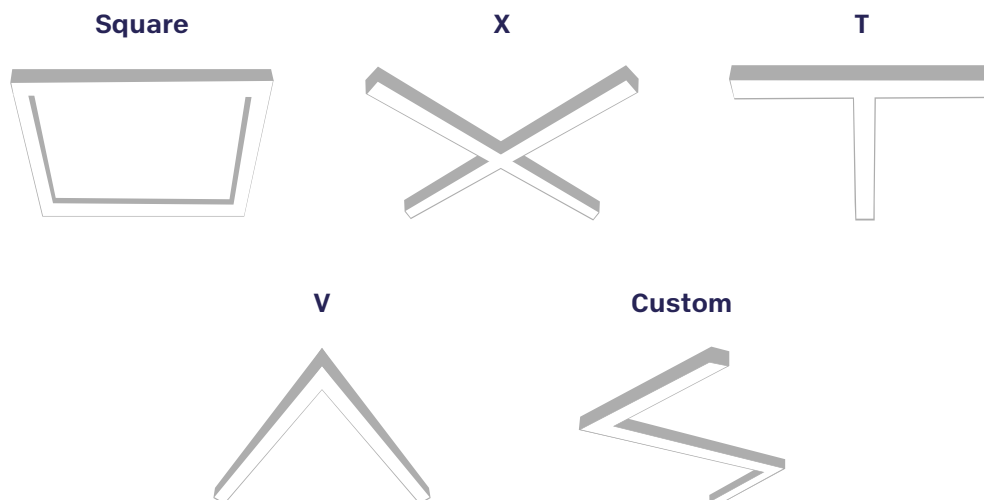

Rush Black Optic recessed

Mounting Options

Custom mounting types and ceiling transitions available; consult factory.

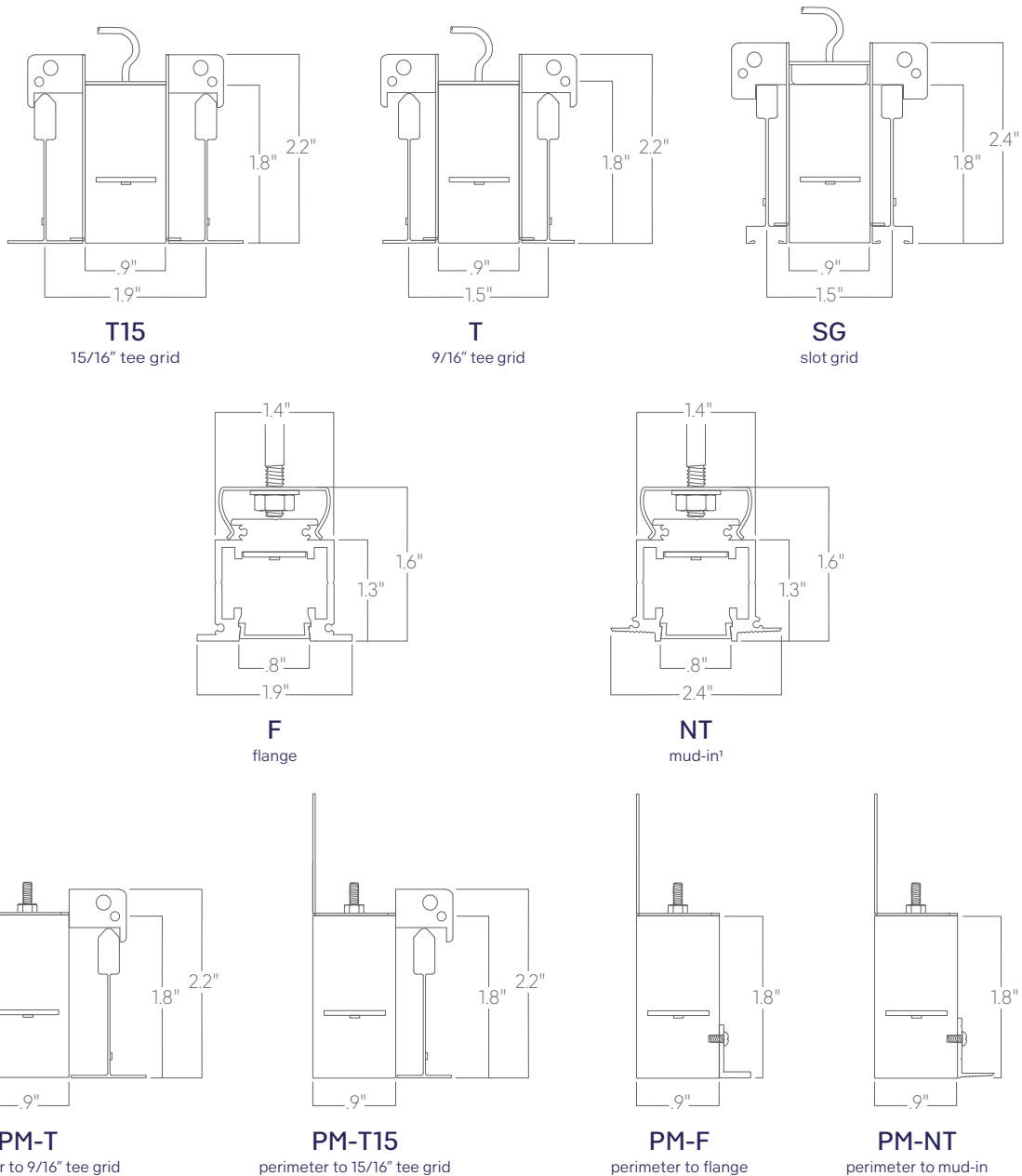

¹Installation that alters aperture width compromises lens security. Installer must ensure aperture width is maintained.

Please consult factory shop drawings for suspension points.

To prevent damage to fixtures, factory designated suspension points must not be field altered.

Do not attempt installation if you do not understand the installation instructions.