

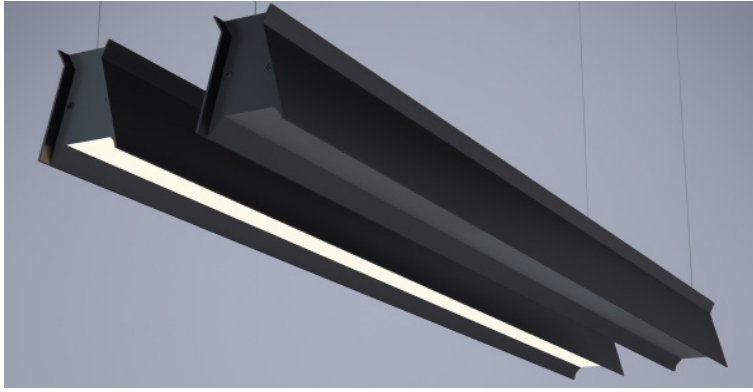



DATE \_\_\_\_\_ PROJECT \_\_\_\_\_ FIRM \_\_\_\_\_ TYPE \_\_\_\_\_



Stylized architectural linear luminaire with direct and indirect lighting. Specially formulated, regressed lens in beveled aperture that allows the unilluminated fixture to seamlessly blend in to dark environments. Perfect for open ceiling applications and architectural spaces.

### FEATURES

- **BLACK OPTIC**
- 100% Direct Lighting
- Available In Made To Measure Lengths Accurate Up To 1/16"
- Patterns Available (See Page 2)
- CRI 90+ Standard; R9>50
- 5 Year, 50,000 Hour Fixture Warranty
- 2700K, 3000K, 3500K, 4000K & 5000K Color Temperatures Available
- Available with PoE

<b>APPLICATIONS</b>	Offices, Lobbies, Retail Stores, Restaurants, Reception Areas & Corridors		
<b>CONSTRUCTION</b>	Extruded Aluminum Housing with Die Cast Ends. Formed Steel Gear Tray	<b>OPTICS</b>	<b>BLACK OPTIC</b> Direct; Satin Acrylic Lens Indirect
<b>WARRANTY</b>	5 Year Limited Warranty (Covers Standard Components)	<b>FINISH</b>	Standard Powder-Coated White. Custom RAL Colors Available
<b>FIXTURE RATINGS &amp; CERTIFICATIONS</b>	Union Made ETL Listed	Made In The USA Damp Location Rated	 
<b>ELECTRICAL</b>	Integral Driver with 0-10V Dimming Standard. Several Driver Options Available		<b>DRIVERS &amp; SENSORS</b>  For Wiring Diagrams and Sensor Information Click <a href="#">Here</a>

### EXTRUSION DIMENSIONS

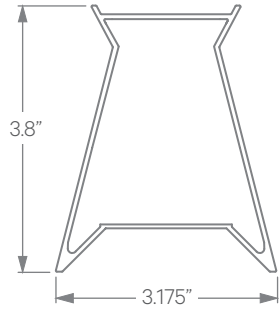

### LED SYSTEM INFORMATION

	Nominal System Watts		Nominal Delivered Lumens	
	DIRECT	INDIRECT	DIRECT	INDIRECT
Standard (LTG1)	5.25 W/ft	5.25 W/ft	105 lm/ft	605 lm/ft
Low (LTG2)	3.5 W/ft	3.5 W/ft	70 lm/ft	420 lm/ft
High (LTG3)	7.5 W/ft	7.5 W/ft	150 lm/ft	785 lm/ft

Based on a 3500K luminaire using one driver. Custom outputs available; specify below.

### ORDERING



<b>1 - FIXTURE ID</b>	<b>2 - LENGTH</b>	<b>3 - COLOR TEMP</b>	<b>4 - LED SYSTEM</b>	<b>5 - VOLTAGE</b>	<b>6 - DRIVER</b>
PIER UPDN BKO	4 - 4 ft 8 - 8 ft X'-X" - Specify Length (4" Increments) PAT - Pattern (Consult Factory)	27 - 2700K/90 CRI 30 - 3000K/90 CRI 35 - 3500K/90 CRI 40 - 4000K/90 CRI	<b>IN-INDIRECT</b> LTG1 - Standard LTG2 - Low LTG3 - High LTGC - Custom Output	<b>D - DIRECT</b> LTG1 - Standard LTG2 - Low LTG3 - High LTGC - Custom Output	UNV - Universal (120/277V) DB - Standard Dimming (0-10V) DB1% - 1% Dimming (0-10V) DB.1% - 0.1% Dimming (0-10V) LTEA - Lutron 2-wire 1% Dimming (120V only) LDE1 - Lutron Digital EcoSystem LDE5 - 5 Series EcoSystem; 5% Dimming PoE - Power over Ethernet. Consult Factory for Compatibility

### 7 - FINISH

- W - White (Standard)
- BLK\* - Black
- CC\* - Custom Color (provide RAL#)

\*White cord and canopy provided. Must specify for other requests.

### 8 - MOUNTING

- AC - Air Craft Cable (50")
- ACP - Power Over Aircraft Cable

### 9 - CONTROL (Optional)

- EIS - Enlighted Sensor
- WISD - Wattstopper Daylight Sensor
- WISM - Wattstopper Occupancy Sensor
- SLS - SensiLUM Sensor
- ACS - Acuity Controls nLight System
- CCS - Casambi Compatible
- ECS - Eaton WaveLinX System

\*For other control systems not listed consult factory.

### 10 - OTHER OPTIONS

- DC - Dual Circuit (Separate Up/Dn Control)
- EM 120V - Emergency Pack
- EM 277V - Emergency Pack
- EMCKT - Emergency Circuit

DATE

PROJECT

FIRM

TYPE

### MOUNTING OPTIONS

AC - Air Craft Cable (50")

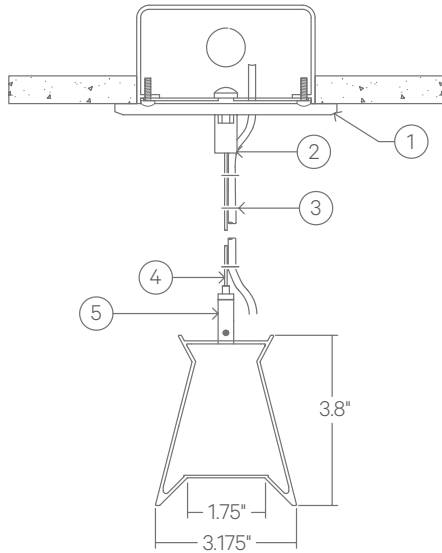

- 1 - 5" Round Canopy (Standard White Finish)
- 2 - Canopy Retainer
- 3 - SJT Cord (Standard White)
- 4 - Air Craft Cable
- 5 - Gripper

### PATTERNS

Patterns feature illuminated corners and angles. **Must consult factory for custom corners, patterns and elevations.**

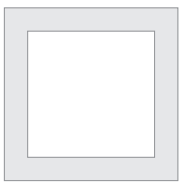

Square Patterns

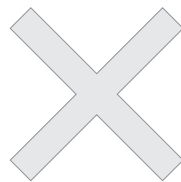

X Patterns

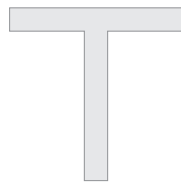

T Patterns



Custom Angles

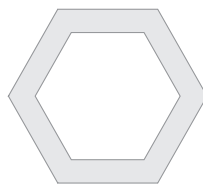

Custom Patterns

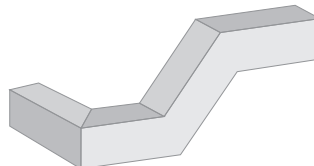

Custom Elevations

### LENS CUT

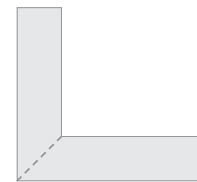

Mitered