

DATE _____ PROJECT _____ FIRM _____ TYPE _____

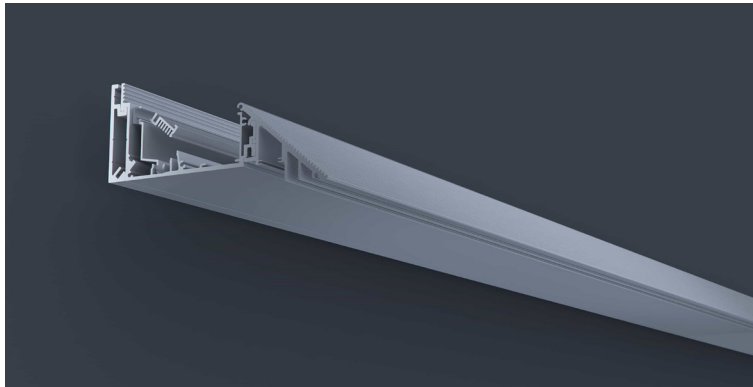

Specially designed cove system with snap-in, field adjustable LED modules providing a 30°, 40°, or 50° angle for optimal light distribution control.

FEATURES

- Available In Made To Measure Lengths Accurate Up To 1/16"
- Damp Location Rated
- CRI 90+ Standard; R9>50
- 5 Year, 50,000 Hour Fixture Warranty
- 2700K, 3000K, 3500K, 4000K & 5000K Color Temperatures Available
- Available with PoE

APPLICATIONS Offices, Lobbies, Retail Stores, Classrooms, Reception Areas & Corridors

CONSTRUCTION Extruded Aluminum Housing with Snap-In Piece Designed to Adjust Angle of LED Modules | **OPTICS** Extruded High Transmission Satin Acrylic Lens with No LED Imaging. Dust Cover Provided

WARRANTY 5 Year Limited Warranty (Covers Standard Components) | **FINISH** Standard Powder-Coated White. Custom RAL Colors Available

FIXTURE RATINGS & CERTIFICATIONS Union Made ETL Listed | Made In The USA Damp Location Rated



DRIVERS

For Wiring Diagrams [Click Here](#)



ELECTRICAL Integral Driver with 0-10V Dimming Standard. Several Driver Options Available

EXTRUSION DIMENSIONS

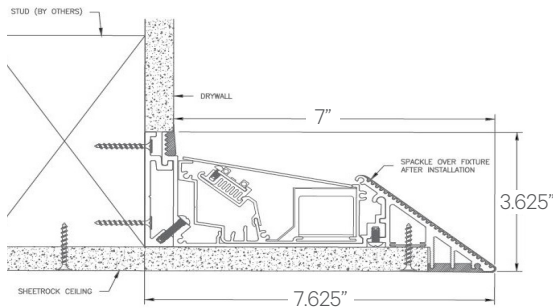

LED SYSTEM INFORMATION

	Nominal System Watts	Nominal Delivered Lumens	Nominal Efficacy
Standard (LTG1)	7.25 W/ft	875 lm/ft	120 LPW
Low (LTG2)	5 W/ft	600 lm/ft	120 LPW
High (LTG3)	10 W/ft	1,165 lm/ft	116 LPW

Based on a 3500K luminaire using one driver. Custom outputs available; specify below.

ORDERING

1	2	3	4	5	6	7	8	9
---	---	---	---	---	---	---	---	---

- | | | | | | |
|---|--|--|---|---|---|
| <p>1 - FIXTURE ID</p> <p>KOVE LED</p> | <p>2 - LENGTH</p> <p>4 - 4 ft
8 - 8 ft
X'-X" - Specify Length</p> | <p>3 - COLOR TEMP</p> <p>27 - 2700K/90 CRI
30 - 3000K/90 CRI
35 - 3500K/90 CRI
40 - 4000K/90 CRI
50 - 5000K/90 CRI
TW* - Tunable White
RGBW** - RGB + 3000K</p> <p>*Must use DMX or TW10 Driver
**Must use DMX Driver</p> | <p>4 - LED SYSTEM</p> <p>LTG1 - Standard
LTG2 - Low
LTG3 - High
LTGC - Custom Output</p> | <p>5 - VOLTAGE</p> <p>UNV - Universal (120/277V)</p> | <p>6 - DRIVER</p> <p>DB - Standard Dimming (0-10V)
DB1% - 1% Dimming (0-10V)
DB.1% - 0.1% Dimming (0-10V)
LTEA - Lutron 2-wire 1% Dimming (120V only)
LDE1 - Lutron Digital EcoSystem
LDE5 - 5 Series EcoSystem; 5% Dimming
PoE - Power over Ethernet. Consult Factory for Compatibility
DMX - For Color Tuning and RGBW (Remote)
TW10 - Dual Channel, 0-10V For Color Tuning (CCCT and Intensity Control)</p> |
|---|--|--|---|---|---|

- | | | |
|---|---|--|
| <p>7 - FINISH</p> <p>W - White (Standard)
CC - Custom Color (provide RAL#)</p> | <p>8 - BEAM ANGLE</p> <p>30°
40°
50°</p> | <p>9 - OTHER OPTIONS</p> <p>EM 120V - Emergency Pack
EM 277V - Emergency Pack
EMCKT - Emergency Circuit</p> |
|---|---|--|