



DATE

JOB NAME

TYPE

Features	Applications
----------	--------------

- Fixture components snap together for ease of installation and maintenance
- Knock-outs provided for convenience outlet, pull switch and conduit attachment

- Office Areas
- Retail Stores
- Class Rooms
- Libraries
- Restaurants

Series	Size	Lamps	Watts	Voltage	Options
S					
	2FT	1	17W T8	120	EM-EM Pack
	4FT	2	14W T5	277	EM2-EM Pack 2-Lamp
	5FT	3	24W T5HO	UNV	DB-Dimming Ballast
	6FT		20W T12	(T12 dedicated	SC-Separate Circuit
	8FT		25W T8	voltage only)	MS-Motion Sensor
			21W T5		WG-Wireguard
		39W T5HO	32W T8		AS-Asymmetric Reflector
		30W T12	28W T5		SR-Symmetric Reflector
			54W T5HO		CH- Chain Hangers
			58W T8		PS- .71 Low Factor program-start ballast
			40W T12		
			59W T8		
			86W T8HO		
			96 T12		

Ordering Example: S-232WT8-UNV-EM

Details

Application Features: Specification grade fluorescent channel. For use in indoor applications where a T8, T5, T5HO, or T12 striplight with tool-less design and low cost is required. Available in 2', 3', 4', 5', 6' and 8' lengths.

Construction: Die formed 20 ga. cold rolled steel housing. Fixture components snap together for ease of installation and maintenance. Sufficient knock-outs provided for convenience outlet, pull switch and flexible conduit attachment. Weighs approx. 7lbs.

Finish: Baked white enamel.

Electronic: Electronic ballasts are class P, thermally protected.

Approvals: Union made, UL listed, and manufactured in the US.

Options: Emergency Battery Backup, Dimming Ballast, Separate Circuit, Motion Sensor, Wireguard, Asymmetric Reflector, Symmetric Reflector.

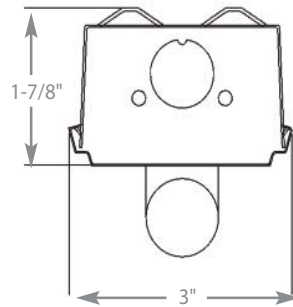

END VIEW
1-LAMP

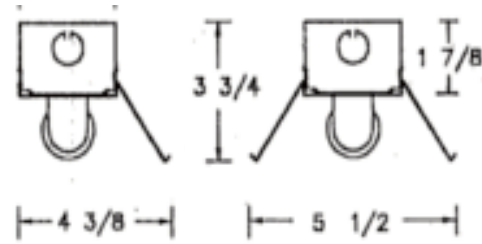

ASYMMETRIC SYMMETRIC

REFLECTOR END VIEWS
1-LAMP

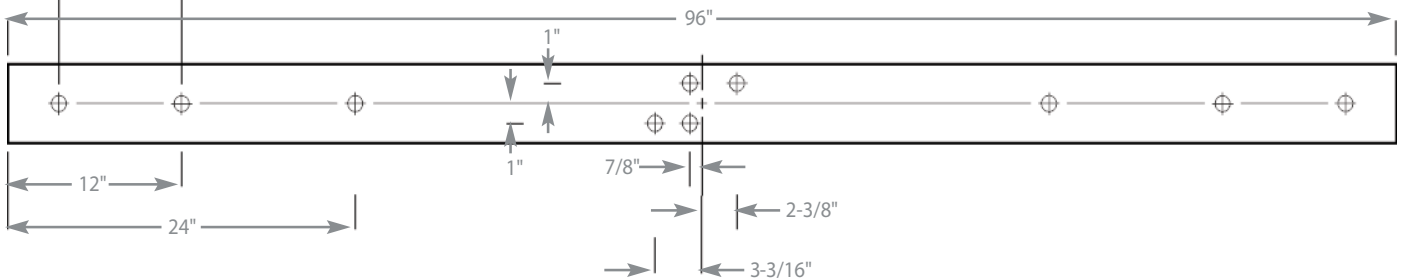
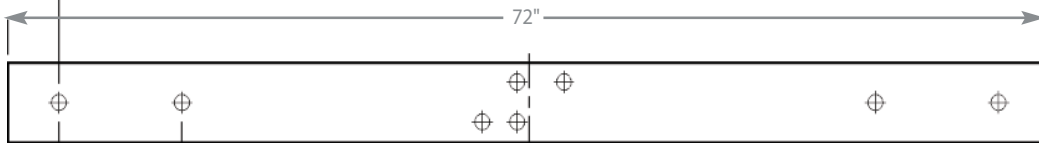
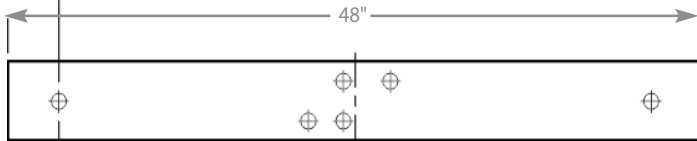
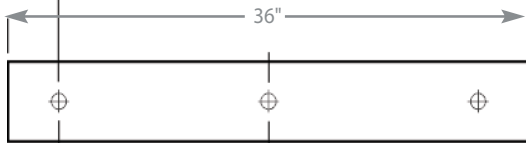
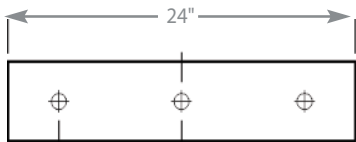

TOP VIEWS

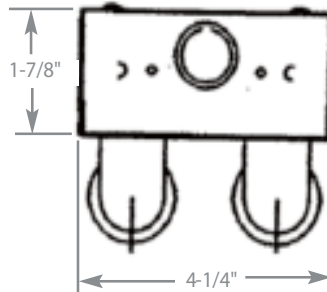

END VIEW
2-LAMP

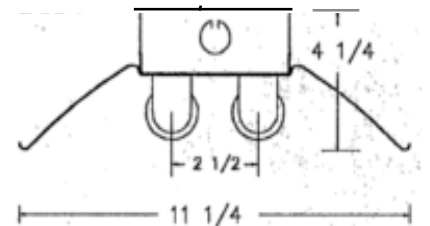

SYMMETRIC REFLECTOR
2-LAMP